

# PORTLAND CNC

## Duct Tower

Thanks for buying a Duct Tower!

### Installation

Installing our Duct Tower is easy.

- **It's critical to fully align your ducting to one side** of the machine. See guide at QR code below.
- **Install Duct Tower on same side as ducting.** (It works on either side of a ShopSabre PRO or IS, HSD 5HP or 10HP z-stiffener.)
- See Install Diagram on Back of Page
  1. **Pre-assemble** larger Tower and smaller Brace parts starting with the middle (3) bolt holes using M8x25mm SHCS and locknuts loosely.
  2. **Slip assembly** over Z-Stiffener.
  3. Attach M8 Double Plates (2) with M8x16mm (4).
  4. Choose Angle and **Mount Claw** with M8x16mm (2) and locknuts (2).
  5. Attach Ducting with Duct Wrap and Rubber Twist Tie to claw.

TIPS, VIDEOS, & FAQs



### Need Help?

Check our Help Documents: [pdxcnc.com/help](http://pdxcnc.com/help)  
[help@portlandcnc.com](mailto:help@portlandcnc.com)

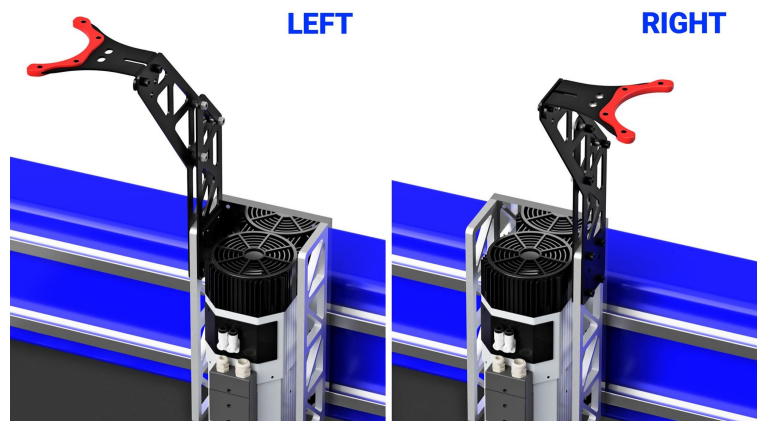
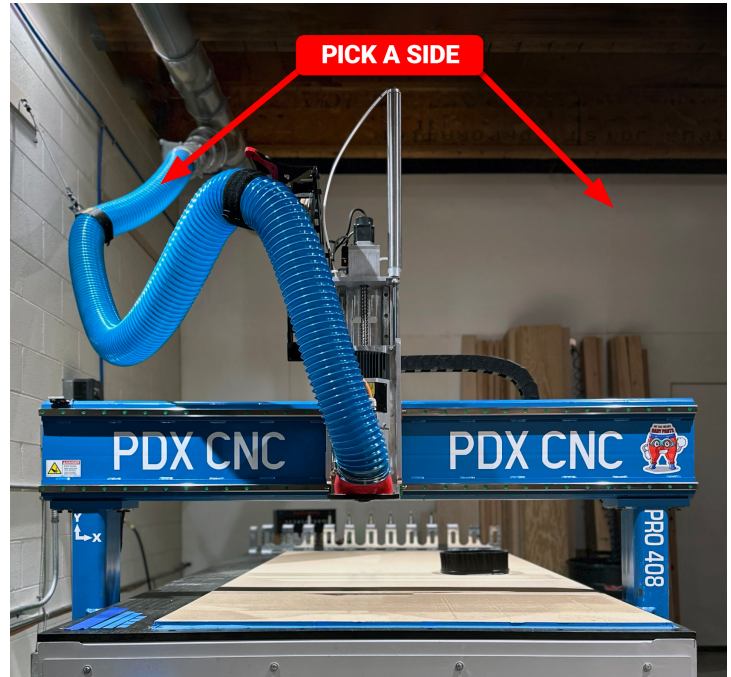

### Get Additional Duct Control



[shop.pdxcnc.com](http://shop.pdxcnc.com)

# Duct Tower Assembly

Duct Tower can be mirrored

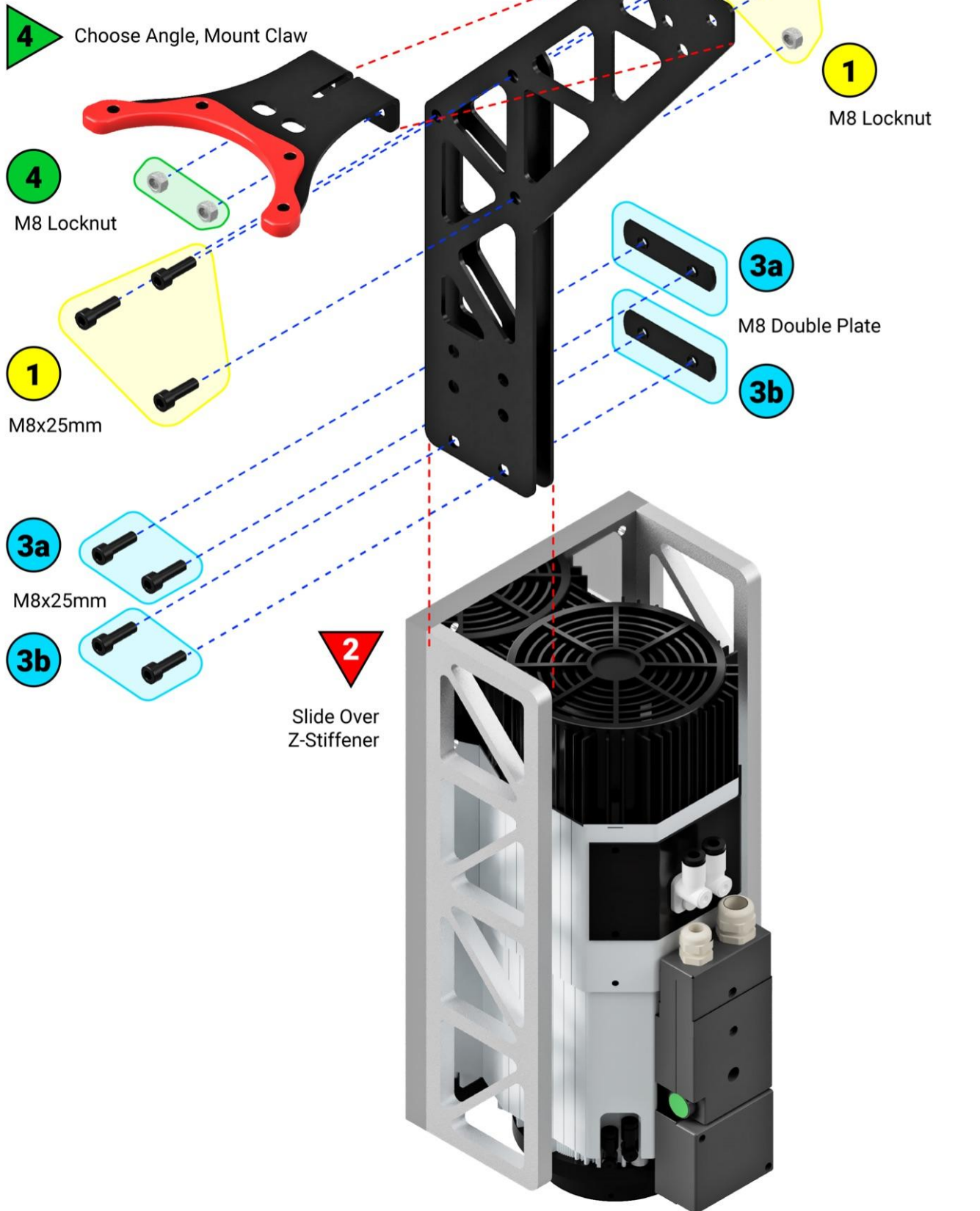

Duct Tower works fantastically with our Dust Boot with **89% more CFM** – [pdxco.co/db](https://pdxco.co/db)